

<b>KERN-LIEBERS</b> TEXTILE	<b>Form</b> <b>GBT-BNL-FOR-C100-07-00</b>	KLPS: –
	<b>Inquiry form</b> KERN-LIEBERS Textile GmbH Niederlassung Bayerische Nadelleistenfabrik Paul Leistner Phone: +49 (0) 9122 9286 – 0 / Mail: info-bnl@kern-liebers.com	

Inquiry from:

Company:

Contact person:

Phone:

Mail:

**Data sheet for cold perforation**

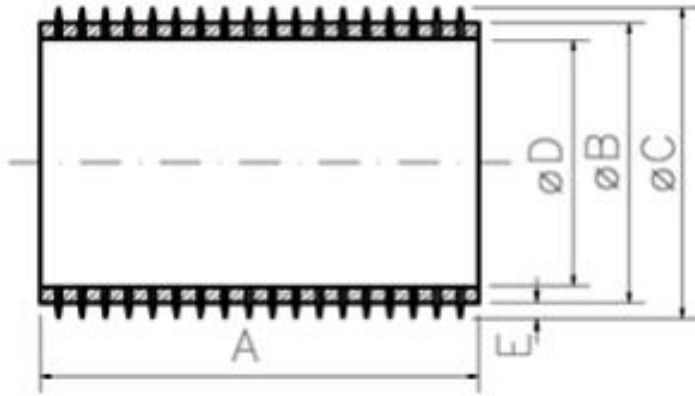

A (mm):

B (mm):

C (mm):

D (mm):

E (mm):

Material Pipe:

**Carrier axis**

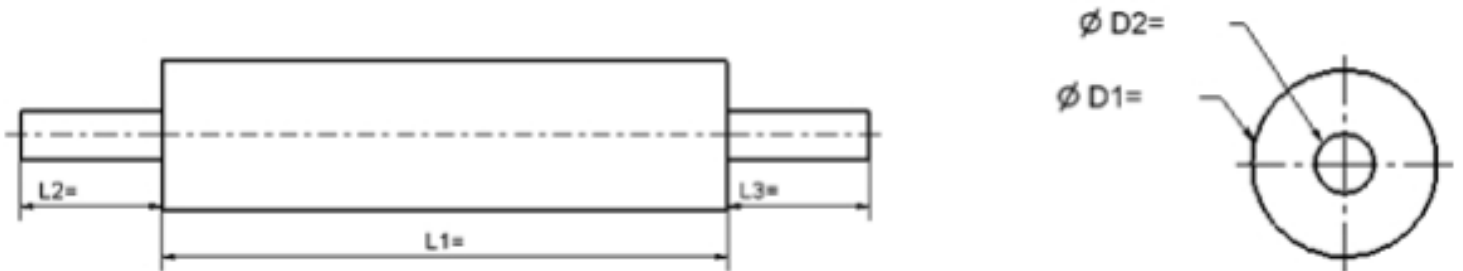

Roll body length L1 =

Roll body diameter D1 =

Pin length L2 =

Pin fixed/bearing:

Pin length L3 =

Roll material:

Pin diameter D2 =

Pin material:

Print date:	02.04.2024	Page 1/2	Author:	MAH/25.03.2024
Rev. Status	00	<a href="#">GBT-BNL-FOR-C100-07-00_Inquiry form.docx</a>	Approval:	JOG/28.03.2024

<b>KERN-LIEBERS</b> TEXTILE	<b>Form</b> <b>GBT-BNL-FOR-C100-07-00</b>	KLPS: –
	<b>Inquiry form</b> KERN-LIEBERS Textile GmbH Niederlassung Bayerische Nadelleistenfabrik Paul Leistner Phone: +49 (0) 9122 9286 – 0 / Mail: info-bnl@kern-liebers.com	

For short lengths, the needles can also be inserted directly into the carrier axis by gluing. The metal adhesive is heat-resistant up to 170 degrees Celsius, as well as resistant to oil and water.

**Needle pattern A:**

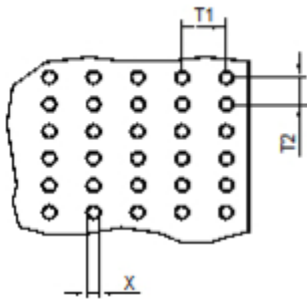

**Needle pattern B:**

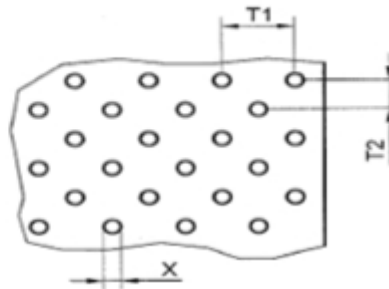

Rolling motion:



Needle pattern:  A  B

T1:

T2:

X:

Multiple or spiral needling according to drawing or sketch possible!

**Mounting holes**



**Number, angle and spacing:**

**Type (e.g., countersunk hole Din 74 Am5):**

**Edge distance (mm):**

**Hole spacing (mm):**

**Special features, specific requirements, quantities or other comments:**

Print date:	02.04.2024	Page 2/2	Author:	MAH/25.03.2024
Rev. Status	00	<a href="#">GBT-BNL-FOR-C100-07-00_Inquiry form.docx</a>	Approval:	JOG/28.03.2024